



AN INSPIRING OASIS

Discover a magical retreat at The Boulders, A Waldorf Astoria Resort. Named for the 12 million-year-old granite formations that define the landscape, the resort is nestled on 1,300 acres in the Sonoran Desert foothills of Carefree, Arizona – just north of Scottsdale. Relax within 160 spacious casitas, 55 villas and six haciendas, naturally sculpted within the ancient boulders, overlooking the mature sun-streaked desert landscape or bordering the resort's championship golf courses. For the most discerning traveler, the exclusive Villa Retreat – two side-by-side estate homes set on private grounds within the property, perfect for corporate retreats or VIP Meetings. Sample innovative cuisine prepared from the freshest local ingredients – many from the resort's own organic garden. Rejuvenate and relax at the Golden Door Spa at The Boulders or partake in adventure with many daily activities. A warm sense of renewal awaits you in a peaceful, stunning atmosphere.

FIRST-CLASS SERVICE

• STUNNING DESERT VIEWS

• WORLD-RENOWNED SPA

RUGGED LUXURY

• SPACIOUS MEETING FACILITIES

• CHAMPIONSHIP GOLF



ACCOMMODATIONS

- 160 guest Casitas
- 55 one-, two- and three-bedroom Pueblo Villas and six Haciendas
- Villa Retreat-5,000 Sq. Ft. (5-Bedroom/5-Bath). Private "Estate-Away-from-Home" Experience

ACCOMMODATION FEATURES

- Private Patio or Balcony with Desert or Golf Course Views
- Mini-Bar and Walk-In Closet
- Workspace and high-speed Internet access
- Spacious bathroom with oversized bathtub, luxurious linens and robes
- Ceiling Fans
- Wood Burning Fireplaces

RESORT AMENITIES & RECREATION

- The 33,000-square-foot Golden Door® spa blends Eastern and Western influences in its design, healing methods, treatments and philosophies. It weaves the philosophy and vision of the original Golden Door in Escondido, California with the Native American and Southwestern influences of this desert oasis. The spa features:
 - 24 treatment spaces
 - Movement studios, providing an array of classes which include Pilates, Yoga, Tai Chi and spin classes
 - The Labyrinth, a path to tranquility inspired by the ancient Hopi medicine wheels
 - The Watsu, offering an underwater "back-to-the womb" experience
 - Private locker rooms, featuring steam rooms, saunas and Japanese baths
 - Full-Service Salon
- Dining
- Two Jay Morrish-designed championship 18-hole golf courses and The Boulders Golf Academy for private or group instruction
- Tennis Garden with eight courts, offering private lessons and weekly clinics
- Four swimming pools
- Desert hikes, mountain bike tours, horseback riding, rock climbing, hot air balloon rides, biplane flights, desert Jeep tours and Grand Canyon tours
- Convenient access to El Pedregal at the Boulders, comprised of an array of posh specialty stores, restaurants and galleries

GUEST SERVICES

- | | |
|--------------------------------------|-------------------------|
| - Concierge | - In-Room Dining |
| - Business Center | - Safety Deposit Boxes |
| - Wi-Fi throughout the Resort | - Newspaper Delivery |
| - Helicopter Pad | - Dry Cleaning |
| - Transportation & Airport Transfers | - Valet or Self Parking |
| - Full-Service Salon | - Gift Shop |
| - Customized Tours | - Sundry Shop |

DINING

- Latilla, the resort's signature dining room, serving New American cuisine inspired by the Southwest
- Palo Verde featuring Southwestern-inspired fare with breathtaking views of the 6th fairway
- Bogey's Sports Bar at the Boulders Club
- Rusty's Grill at The Boulders serves a menu of steak and seafood
- The Golden Door Spa Café features light meals, fresh juices and smoothies
- Bakery Café featuring salads, sandwiches and freshly baked pastries

MEETINGS & EVENTS

Host extraordinary meetings and special events amidst the brilliant color and beauty of the Sonoran Desert.

Nestled among 12-million-year-old boulder formations and scenic foothills, The Boulders is the perfect choice for unforgettable gatherings. Unleash your creativity in spacious function rooms bursting with elegant Southwestern décor and stunning views of sun-splashed terrain.

Book your next special event at our dazzling Carefree retreat.

- 17,800-square-foot Tohono Conference Center
- Fifteen meeting rooms accommodating groups from 10 to 400.
- Asymmetrical walls, floor-to-ceiling windows, outdoor space and adobe fireplaces
- Three executive casitas for smaller conferences and retreats

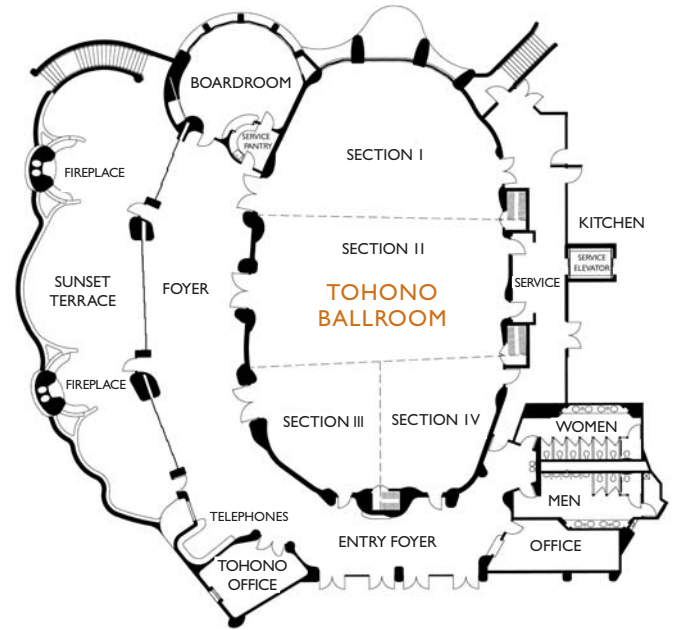

LOWER LEVEL

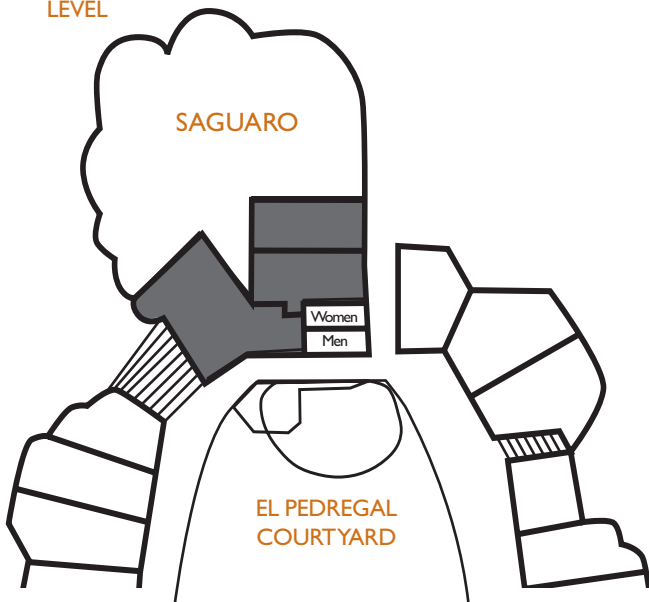

UPPER LEVEL

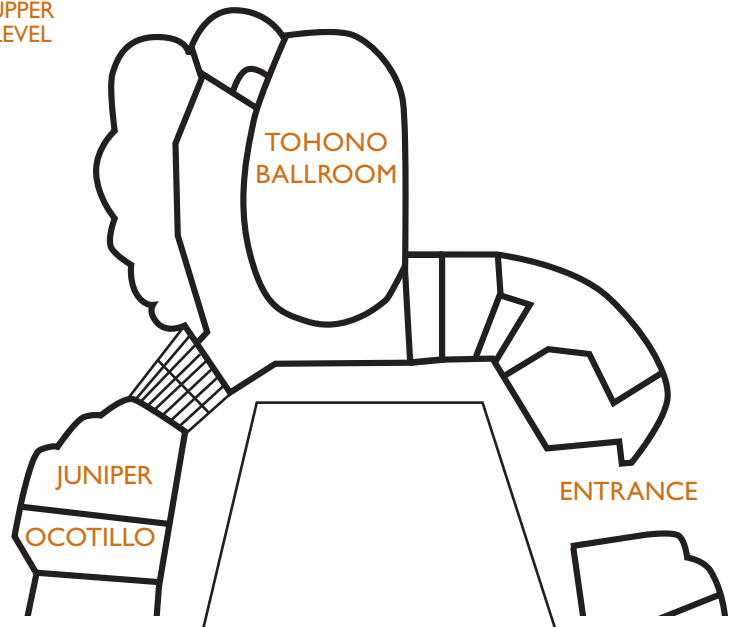

Room Name	Dimensions	Sq. Ft.	Theater	Schoolroom	U-Shape	Conference	Reception	Banquets	Hollow Square	Ceiling Height
Tohono Ballroom	89'6" x 60'	5,370	500	325	66	–	550	400	80	16'
Section I	34'6" x 50'	1,720	110	80	35	30	120	90	40	16'
Section II	34' x 60'	2,050	200	120	40	30	200	130	55	16'
Section III	29' x 27'	788	80	40	20	22	80	50	18	16'
Section IV	31'6" x 25'10"	812	85	45	22	25	85	55	18	11'6"
Tohono Office	15' x 34'	510	25	12	10	12	–	20	10	11'
Foyer	96' x 24'	3,230	–	–	–	–	300	150	–	–
Sunset Terrace	104' x 26'	2,740	–	–	–	–	275	150	–	–
Lyon Den Boardroom	23' x 26'	595	–	–	–	16	–	–	–	11'
Juniper	42' x 40'	1,680	–	80	30	30	100	70	32	11'
Ocotillo	20' x 40'	800	40	30	15	20	50	30	18	11'
Saguaro	55' x 52'	2,860	80	50	35	40	150	100	35	11'
El Pedregal Courtyard	60' x 100'	7,350	–	–	–	–	550	230	–	–

SONORAN BALLROOM at THE LODGE

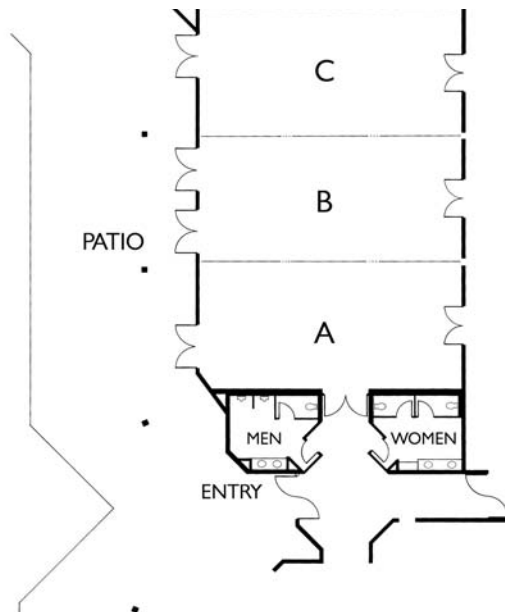

THE CLUBHOUSE

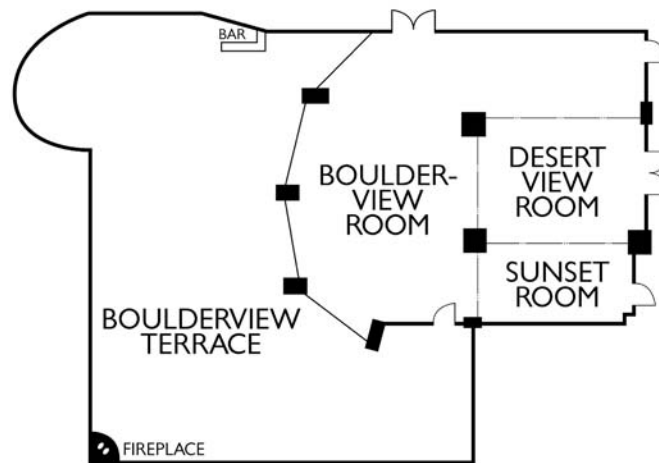

Room Name	Dimensions	Sq. Ft.	Theater	Schoolroom	U-Shape	Conference	Reception	Banquets	Hollow Square	Ceiling Height
Sonoran Ballroom	52' x 37'	1,925	150	96	50	60	150	96	60	11'6"
Section A, B, or C	17'6" x 37'	651	50	30	26	26	60	24	25	11'6"
Section A&B or B&C	35' x 37'	1,302	100	60	40	34	110	48	48	11'6"
Sonoran Patio	18' x 32'	576	-	-	-	-	80	40	-	-
The Clubhouse	41' x 46'	1,886	100	25	-	-	150	108	-	10'
Boulderview Room	25' x 40'	1,000	20	20	21	21	30	45	-	10'
Sunset Room	11' x 23'	253	15	6	-	10	-	18	-	10'
Desert View Room	16' x 23'	368	25	12	10	12	-	27	-	10'
Boulderview Room	54' x 61'	3,294	-	-	-	-	150	110	-	-
Cocopeli	54' x 48'	2,592	-	-	-	-	200	150	-	-
Boulders Suite	24' x 19'	480	-	-	-	14	75	-	-	-
Duck Pond	90' x 125'	11,500	-	-	-	-	225	200	-	-
Organic Garden	83' x 61'	6,600	-	-	-	-	75	50	-	-
19th Green	39' x 90'	3,600	-	-	-	-	150	120	-	-
Promise Rock	52' x 40'	2,040	120	-	-	-	100	80	-	-